



SCHOOL OF DENTAL MEDICINE
CASE WESTERN RESERVE
UNIVERSITY

**Case WREB
Dental Candidate Information Manual**

Western Regional Examining Board
March 15 – 18, 2019
(Friday – Monday)



We at Case Western Reserve University welcome you to our School of Dental Medicine. This manual was developed to help you get acquainted with our facility and its ancillary support systems. We wish you well on this leg of your journey in the profession of Dentistry.

Case Western Reserve University School of Dental Medicine is making its facilities available to the Western Regional Examining Board (WREB) as a testing site.

This handout is intended to address questions you may have regarding the facility and its role in the examination. If you need any additional information or clarification please contact the Office of the Associate Dean for Administration at 216-368-1900 or gmi7@case.edu. However, please **do not** call the school for any interpretation of material contained in your Candidate Manual.

Questions regarding the examination itself (content, patient requirements, paperwork/forms, etc.) should be directed to the WREB office: (623-209-5400)

www.wreb.org

PATIENT PROCUREMENT

Patient brokering, i.e., the selling of patients, will not be tolerated under any circumstances within the School of Dental Medicine and/or on the premises of the university. Violation of this rule will result in immediate removal from the campus of the university.

You must provide your own patients. The School of Dental Medicine **will not** furnish any patients or make any of its clinic records available for screening or for use during the examination. Further, the School of Dental Medicine has no external sources from which the potential patients can be drawn. You are strongly advised to bring your own patients with you. If you cannot, you will need to explore other alternatives (private practitioners in the area, personal contacts, community shelters, etc.) on your own.

PATIENT SCREENING

Please note that CWRU, School of Dental Medicine **does not** participate in the Provisional Acceptance of Radiographs.

Clinic and radiographic facilities will be available to screen your own patients between **(February 4 and March 14, 2019)**. Screening may be done each day *between 3:00 p.m. and 4:30 p.m.* **No treatment other than screening (clinical/radiographic examination) will be permitted.**

If you plan to take any radiographs **with film supplied by the school**, you must pay the appropriate fee to the cashier prior to any exposures. Payments must be in cash; checks of any kind will not be accepted. Radiograph fees are as follows:

Periapical/bitewing - first film	\$6.00
Periapical/bitewing - each additional film	\$6.00
Bitewing survey - 4 films	\$21.00
Full-mouth survey - 18 films	\$42.00

If you supply your own film, no fee will be assessed. Also, no fees will be charged for radiographs that may be required by the WREB after the examination has started.

EQUIPMENT AND SUPPLIES

The following clinic/laboratory supplies will be furnished during the examination:

Amalgam Alloy (single spill)	Impression materials (see following comments below)
Anesthetic - topical and local	Lab stones
Articulating paper	Lubricant (Vaseline)
Autoclave tape	Masks
Bags, biohazard, sterilization	Matches
Calcium Hydroxide (Dycal)	Mouthwash
Cements (see following comments below)	Needles (27 long) and (30 short)
Cotton rolls and pellets	Paper towels
Cotton-tipped applicators	Patient bibs
Cups (Dixie)	Prisma gloss
Disinfectant Caviwipes and Citrace	Prophy paste
Ethyl alcohol (for torches)	Pumices
Evacuation and saliva ejector tips	Retraction cord
Facial Tissue	Non-Latex Rubber Dam and napkins
Floss, unwaxed	Soap
Gauze sponges (2x2)	Temporary crowns (polycarbonate and ion)
Gloves, examination type (non latex)	Tongue blades
Headrest and chair covers	Tray covers
Hemostatic Agent	Trays for instruments (disposable)
Waxes, various	Exaflex Putty (Regular Set) by GC America

Comments:

The Exaflex material will be available at the Dispensary window and **must** be mixed there.

The putty matrix index must be completed prior to receiving permission to proceed with the Prosthodontic section.

Available impression materials include alginate and vinyl polysiloxane (Aquasil) **only**. You **must** provide any other impression materials you wish to use. Cements on hand include, glass ionomer and hybrid glass ionomer, zinc phosphate, zinc oxide-eugenol, and IRM. **We are a non-latex school.**

We **will be** using shrouds/facemasks used in the endo portion of the exam, the kavo units have shrouds/facemasks already installed so please take note of this prior to choosing a site.

Supplies furnished for the endodontic portion are listed below. If you use lateral condensation, you **must** supply your own condensers and master/accessory points. **Hand pieces and motors, hand instruments, condensers, spatulas, etc. and burs will not be provided.**

Sodium Hypochlorite	Irrigation syringe
Files (#10- #80)	Paper points (#45 fine, #60 med, #80 coarse)
Gauze sponges (2x2)	Pulp canal sealer (Roth)
Gutta percha	Radiographic film (Clinasept IP-2IC #2 Insight)

For the Endodontic examination in the Den Sim Laboratory, two conventional x-ray units will be provided plus 3 periopro automatic wet developers.

You will be using **automatic developers** to process your post-treatment endodontic radiographs. Since your films will be wet processed, you may wish to bring a small portable hairdryer to expedite the drying/mounting of your radiographs.

You **must** furnish your own equipment (**hand pieces and motors, burs, hand instruments, anesthetic syringes, casting rings, investment materials impression trays, casting torch, etc.**) Case **will not** provide the cavitron and cavitron tips, you **must** bring your own cavitron + tips to the exam. If an item is not on the foregoing lists, bring it with you. *The School will assume no responsibility for any omissions in your armamentarium.*

Additionally, for the Endodontic portion of the examination you will need to purchase an Endodontic tyodont model # MP_E 120_PC. This model is the Magnetic Mount. This may be purchased from the following sources:

Henry Schein Store
Case School of Dental Medicine
2124 Cornell Road
Cleveland, Ohio 44106
216-368-2771
www.acadental.com/WREB

EQUIPMENT RENTAL

Clinical instruments, hand pieces (high speed and low speed), sonic and ultrasonic scalers **will not** be available for rental.

All air driven hand pieces are six (6) hole (pictured) in our clinics. If you have a four (4) hole, you will need to provide an adaptor to get to six (6) pin. A four (4) hole hand piece **may** leak air therefore, you would need an adapter to convert the hand piece into a six (6) hole.



The School has Bien Air Electric handpiece Control boxes in all operatories in the DMD Clinics and Simulation Clinic. The hand pieces themselves adapt to:

Bien Air MX2 LED MOTOR # 1600677-001

High Speed # CA 1541

Slow Speed (Latch) # CA 1142

Nose Cone # PM 123

All use 6 pin hoses



All Electric Hand pieces use Bien Air Hose MX2 400 Grey # 1600700-001

http://www.bienair.com/catalogs/EN/Catalogue_Bien-Air_Dental_EN/catalogue_dental_en.html#136

The Air Driven Hand pieces use Bien Air Hose #1600097-001 SN 11D

http://www.bienair.com/catalogs/EN/Catalogue_Bien-Air_Dental_EN/catalogue_dental_en.html#142

Extra Information regarding the electric hand pieces CWRU students receive:

- MX2 electric micro motor
- CA 1:5 Electric High-speed Hand piece
- CA 1:1 Electric Slow speed Hand piece
- PM 1:1 Electric Straight Hand piece
- They also received an Air Driven High-speed which is the Bora L, and it uses the Unifix 4H L coupling

If you have any questions or concerns regarding hand pieces related to the board exam, please e-mail Mr. Adam Majette at axm696@case.edu

Case students here use two types of Cavitrons: Turbo Sensor and Dentsply Cavitron Plus. You would have to bring your own cavitron and tips to take the boards at Case.

Turbo Sensor Ultrasonic Scaler:



For more information on the Turbo Sensor: <http://www.parkell.com/Products/374/TurboSENSOR>

Dentsply Cavitron Plus:



For more information on the Cavitron Plus: <https://www.dentsply.com/en-us/preventive/ultrasonic-scaling/table-top-units.html/Preventive/Ultrasonic-Scaling/Table-Top-Units/Cavitron-Plus-Ultrasonic-Scaler-with-Tap-On-Technology/p/8184001.html#tabs=Features%20and%20Benefits>

If you plan to do any laboratory work in the second floor laboratory, you will also have to utilize equipment that adapts to a four hole system. If you utilize the clinic floor laboratory, you will need a moto tool.

If you have questions in this regard, please contact the Associate Dean for Administration at (216) 368-1900.

The school's in-house student store is open Monday-Friday 8:00 a.m. to 5:00 p.m.; the Henry Schein Store will be available thru Saturday during WREB. Inventory is very limited and designed to accommodate our students' needs. Therefore, you are encouraged to contact any of the local dental suppliers listed below if you wish to purchase any instruments or equipment:

Henry Schein	216-368-2771
Patterson Dental	440-891-1050
Benco Dental	1-800-462-3626

CLINIC OPERATORY EQUIPMENT

Each clinic operatory is equipped with Adec units. The operatory unit has:

1. Bien Air Hose #1600097-001 SN 11D This tubing has coolant water fiber optics and is used with the Air driven high-speed hand piece, Bien Air 6 pin (hole) fiber optics.
2. The control box is available for the Bien Air Electric High Speed, air driven optic high speed with coupling, Bien Air Hose MX2 400, Grey #1600700-001
3. Tri-function air/water syringe
4. There is also a side mounted view box for radiographs.
5. A quick-connect water source for ultrasonic scalers.
6. If you prefer to use the electric hand piece, ***you would need to bring:*** latch type electric hand piece, nose cone electric hand piece, MX micro-motor

LABORATORY EQUIPMENT

The clinic laboratory on the main clinical floor has 20 individual bench spaces with air, electrical and gas outlets only. It also has one model trimmer, two vibrators, one vac-u-spat mixer, three burnout ovens (one at 600° and one at 1200°) and three casting wells. **You must furnish your own hand pieces and engines, alcohol lamps or bunsen burners and torches.**

The Preclinical East and West Laboratories on the second floor have seventy individual bench spaces, each equipped with high and slow speed hoses with four hole Midwest style connectors and air and gas outlets. They also have four model trimmers, four vibrators, one combination vac-u-spat mixers, three burn out ovens (three at 600° and three at 1200°) and twelve polishing lathes.

You must furnish your own alcohol lamps or bunsen burners and torches.

Please note:

These rooms will be used for the endodontic and prosthodontic portions of the examination during the day. The west lab will be available for laboratory work in the evenings from 5:00 p.m. to Midnight only. **Waxing and casting procedures during the day must be done in the clinic laboratory on the ground floor between the two main clinics. If needed as part of the examination.**

EQUIPMENT MALFUNCTIONS

If you experience any equipment malfunctions report them to the Office of the Associate Dean for Administration at extension (216) 368-1900 or extension (216) 368-6823. An on-site technician will be sent immediately to your area to affect the necessary repairs.

We encourage the Candidates to visit our school ahead of the scheduled exam to try their instruments and make sure that they are working properly to avoid any accidents during the actual examination. Please feel free to call Ms. Gladys Ina to schedule a date and time for the visit at 216-368-1900

EXTERNAL LABORATORY WREB allows the use of commercial laboratories for the cast gold procedure. The following is a partial listing of laboratory services in the area (consult a local phone directory for others that may be available):

ROE	216-663-2233
DSG	1-800-447-3941

INFECTION CONTROL

Universal Precautions

The School requires the use of universal barrier protection (gloves, face masks, eyewear, and protective clothing - clinic coats, gowns) during all direct patient contact. Gloves and face masks will be made available, but you will be responsible for providing OSHA-acceptable eyewear for you and your patients.

Clinic Attire

You must provide your own clinic attire which must meet any standards imposed by WREB. The school will provide clinic coats and gowns to be worn only in the clinic areas. They may not be worn outside the treatment area.

Surface Asepsis

Use of wipe and wire technique for surface disinfectant of the clinic operatory (patient chair, operator and assistant cart/stools, light handles, counter tops, etc.). The following materials and supplies will be available in the clinics for appropriate infection control purposes:

- Calviwipes (at each operatory)
- Citrace spray (at each operatory)
- Plastic chair covers for the dental chair
- Barrier film to cover unit light and handles after disinfection
- Syringe sleeves for air/water syringe handles
- Red biohazard bags for disposal of contaminated items

Hazardous Waste Disposal

Place contaminated items (gloves, used gauze, cotton rolls and such disposable as saliva ejectors and evacuation tips) in the plastic red biohazard bag provided. At the end of treatment, deposit these bags in the biohazard-labeled trash-labeled trash receptacles located in each clinic.

Sharps/Amalgam Disposal

Place all needles, scalpel blades, and other sharps in the red plastic sharp containers located in every aisle. Place all amalgam scrap in plastic amalgam scrap containers also located in every aisle.

STERILIZATION

The main sterilization facility is located on the ground floor. The sterilization schedule will be posted during the examination. Sterilization bags will be available on the Clinic Floor. You must clean/bag your instruments and appropriately identify them to ensure their return to you. Sterilization will not accept any items that have not been appropriately prepared (including candidate identification).

EMERGENCY PROTOCOL

For the management of medical emergencies at the School of Dental Medicine, a medical emergency kit is available at the dispensary for both the A and B clinics. Positive pressure oxygen is available in each clinic, and ammonium capsules are available in each operatory. Posted on the wall of each clinic will be the Emergency Protocol of the School. A copy of this protocol is attached (please refer to page 10).

DIRECTIONS TO THE SCHOOL OF DENTAL MEDICINE

The School is located on the corner of Cornell Avenue and Emergency Drive, approximately seven miles from the Martin Luther King Avenue exit off of Route 90 in Cleveland. A map of the city is included in this handout with the school's location highlighted for your reference. If you need additional assistance in finding the School, please call 216-368-1900.

TOUR

The Candidate tour is held prior to Candidate Orientation from 12:30 pm – 1:15 pm

PARKING

Ample parking for you and your patients is located directly behind the School in the Medical Sciences Garage located on Circle Drive, or in several lots on Cornell Avenue as you approach the School. **Parking is free on Sunday only.**

FOOD/LUNCH FACILITIES

The Student Commons (1st Floor, south end) has numerous food vending machines and a microwave oven for your use. The hospital is located across the street from the school as a main cafeteria and several snack areas. There are also numerous restaurants located on Euclid Avenue just East of the North of the school. Information desk staff will be happy to provide you with additional information about local restaurants and other facilities. On the examination date, a light breakfast and lunch will be provided for Candidates **ONLY.**

Please **DO NOT** take Candidates' food for your patients.

HOTELS AND MOTELS

Some of the hotels/motels relatively close (within 5-15 miles) to the school are listed below. Consult the local telephone directory for additional accommodations:

On Campus/Short driving distance:

Courtyard Marriott	2021 Cornell Road (down the street)	216-791-5678
Glidden House	Ford Road (located on campus)	216-231-8900
Intercontinental Hotel	8800 Euclid Ave. (corner of Euclid and E. 89 th)	216-707-4300
Cleveland Clinic Guest House	9601 Euclid Ave. (corner of Euclid and E. 97 th)	216-707-4200

(Call and ask to be directed to the Cleveland Clinic Guest House)

Downtown/25 minutes - 30 minutes by automobile:

Crown Plaza Hotel	777 E. St. Clair Avenue	216-771-7600
Embassy Suites	1701 E. 12 th Street	216-523-8000
DoubleTree Cleveland Downtown	1111 Lakeside Avenue	216-241-5100
Marriott Society Center	127 Public Square	216-696-9200
Renaissance Hotel	24 Public Square	216-696-5600
Ritz-Carlton	1515 W. 3 rd Street	216-623-1300
Wyndham Hotel	1260 Euclid Avenue	216-615-7500

Or 877-999-3223

Please contact your hotel choices directly for information about room rates, facilities, proximity to the School of Dental Medicine, transportation, etc.

Do not call the School for this information.

MEDICAL EMERGENCY POLICY and PROCEDURES

POLICY:

- THE SCHOOL OF DENTAL MEDICINE WILL PROVIDE BASIC RESUSCITATION MEASURES WITHIN OUR OWN FACILITY.
- HOSPITAL PHYSICIANS ARE **NOT** AVAILABLE TO COME TO THE CLINIC TO PROVIDE EMERGENCY CARE.
- THE PATIENT IS **NOT** TO BE TRANSPORTED BY SCHOOL OF DENTAL MEDICINE PERSONNEL TO THE EMERGENCY ROOM OF THE HOSPITAL. THIS IS THE RESPONSIBILITY OF THE UNIVERSITY CIRCLE POLICE OR THE EMERGENCY MEDICAL SERVICE.
- NOTIFY CWRU SCHOOL OF DENTAL MEDICINE SAFETY OFFICER AND/OR DISPENSARY MANAGER ANYTIME THERE IS AN EMERGENCY SITUATION.

Procedure # 1 - EMERGENCY SITUATIONS IN CLINICAL AREAS DURING NORMAL WORKING HOURS (8:30 am – 5 pm)

1. Attending student must stay with patient.
2. Attending student summons anyone nearby to call nearest instructor.
3. Attending student and instructor will administer first aid. Basic resuscitative procedures must be initiated as required
 - a. Oxygen is available in each clinic and should be brought immediately to the patient.
 - b. Emergency Kits are located in the DMD Dispensary and Oral Surgery.
 - c. AEDs are located in Oral Surgery and on the wall in the corridor between the A and B clinic.
4. If the instructor requires additional assistance, the **ORAL SURGERY CLINIC** should be called at extension **368-2538 or 368-6749**.
5. If at any time it is deemed that **HOSPITAL EMERGENCY CARE** is indicated, or there is no answer from the Oral surgery clinic, the following steps should be taken:
 - a. Call **UNIVERSITY SECURITY** at extension **368-3333** for transport to University Hospital's emergency room.
 - b. University Security will ask if an ambulance is needed and this should be determined at the advice of the attending Oral Surgery Faculty/Residents or CWRU School of Dental Medicine Safety Officer or by the instructor that takes care of the situation.
6. Do not leave affected person unattended until help arrives.

Procedure # 2 - EMERGENCY SITUATIONS IN NON-CLINICAL AREAS DURING NORMAL WORKING HOURS (8:30 am – 5 pm):

1. Stay with affected person and immediately call for help or summon anyone nearby to call nearest instructor or faculty.
2. Provide basic resuscitation as required.
3. Have the person summoned call the **ORAL SURGERY CLINIC** at extension **368-2538** .If there is no answer from the Oral Surgery Clinic call the **UNIVERSITY SECURITY** at extension **368-3333**.
4. Do not leave affected person unattended until help arrives.

Procedure # 3 - EMERGENCY SITUATIONS IN ALL AREAS AFTER HOURS

1. Call **UNIVERSITY SECURITY** at extension **368-3333**.
2. Provide basic resuscitation as required.
3. Do not leave affected person unattended until help arrives.

IMPORTANT NUMBERS TO REMEMBER AND REFER TO:

<u>Department</u>	<u>Phone number</u>	<u>Remarks</u>
ORAL SURGERY CLINIC	368-2538 368-6749	During normal working hours only (8:30 am to 5 pm)
CWRU SECURITY/POLICE	368-3333	24 hours, 7 days a week
EMERGENCY MEDICAL SERVICE	9-911	First dial 9 for outside line



School Address:
2124 Cornell Road
Cleveland, OH 44016

Gladys Ina
gmi7@case.edu

School of Dental Medicine
Parking

Health Sciences Garage/
Lot S-55: is located under the Dental building.
Veale Parking Lot is located on the corner of Adelbert and Circle Drive

The closest lot is Lot S-55, which covers the area below and around the School of Dental Medicine and School of Nursing. This lot has 2 entrances: one on Circle Drive and the other on Emergency Drive off Cornell Road.

Parking garages on the Case Western Reserve University campus usually charge a maximum of \$10 per day for parking. Payments can be made by credit card or cash during the weekday and credit on Saturdays and Sundays. Parking on the street is free on Sundays **ONLY**

Please find Parking and Driving Directions on the following link:

<https://dental.case.edu/parking/>

Clinic A & B

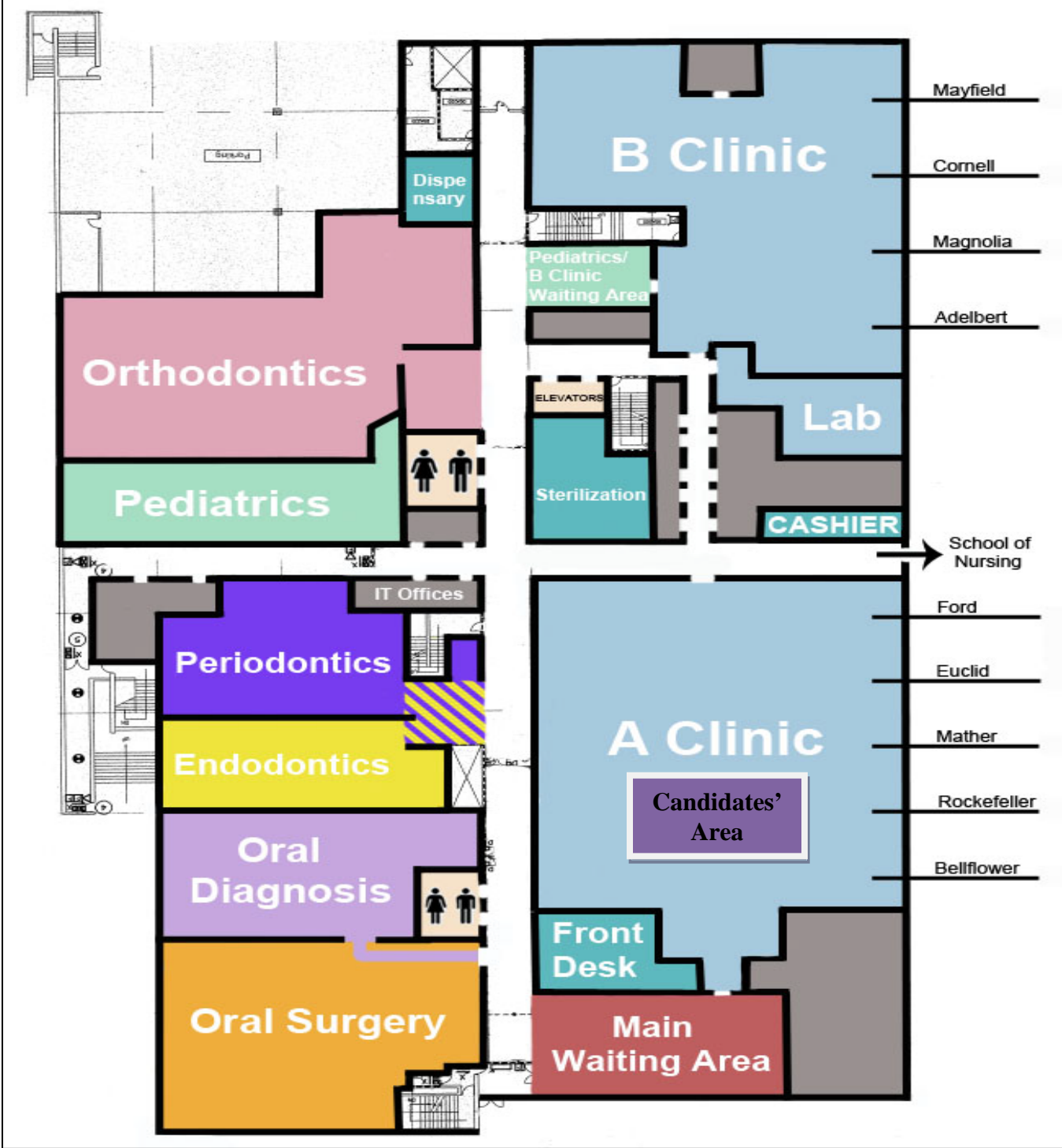

Endo Lab

